



PH-B12-x1xxx-S304

Insulator Material:

0	: PBT
3	: PA6T

 PIN數

	L1	L2	L3	L4
A	4.00	2.00	2.80	0.75
B	3.00	2.00	2.00	0.75
C	3.50	2.00	3.00	0.75
D	2.75	2.00	4.00	0.80

Specifications:

1. Current Rating : 2.0 A
2. Insulator Resistance : 1,000 MΩ Min.
3. Contact Resistance : 20 mΩ Min.
4. Operating Temperature : -40°C ~ +105°C

Materials:

1. Contact : Brass
2. Insulator : PBT / PA6T
3. Contact Plating : Gold over Nickel

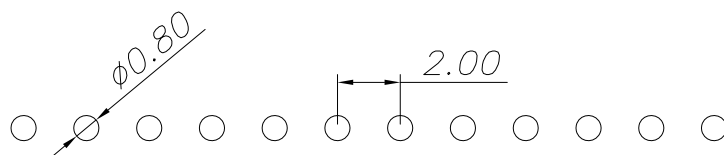
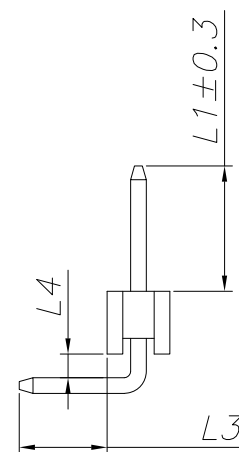
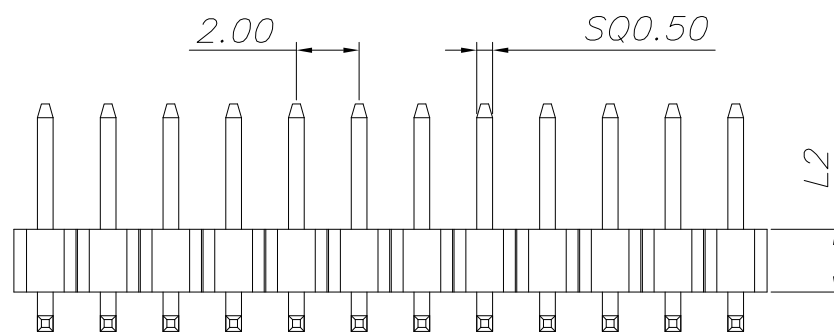
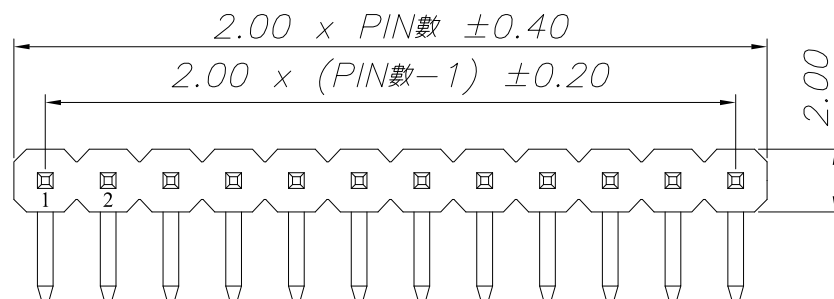

PCB. LAYOUT

ITEM NO.	DESCRIPTION	DRAWN	DATE
4	新增選項	Jack	050521
3	新增選項	Jack	030821
2	新增選項	Jack	062719
1	更新算式	Jack	101518



TOLERANCE UNLESS OTHERWISE STATED :
 Up to 5 ± 0.2
 Above 5 ~ 15 ± 0.3
 Above 15 ~ 30 ± 0.4
 Above 30 ~ 50 ± 0.5
 Angle ± 0.3

3RD. ANGEL'S



UNITS MM

DRAWN BY:	DATE	MAT'L	TITLE	PIN HEADER
Jack Lu	05/05/21			
CHECKED BY:	DATE	FINISH	MODLE	2.0 PIN HEADER 90度 DIP
Jacky Chen	05/05/21			
APPROVED BY:	DATE	SCALE	DWG NO.	PH-B12-x1xxx-S304
Tony Kao	05/05/21	1 : 1		
		SHEET NO.	PART NO.	PH-B12-x1xxx-S304
		1 of 1		

SIZE
A4
VER
R4