

P.C.B LAYOUT
TOP VIEW

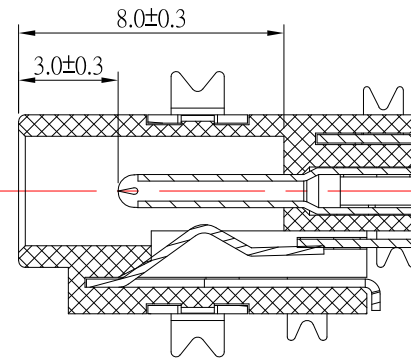

SCHMATIC

DC-067DS-1.0

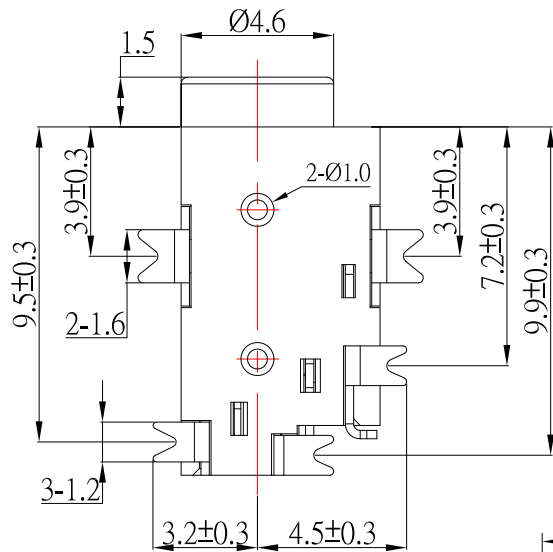
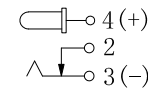

SPECIFICATION

- Rating : DC 30V, 2.0A
- Contact resistance : $\leq 30m\Omega$ Max
- Insulation resistance : $\geq 100M\Omega$ Min
- Withstand voltage : 500VAC
- Insertion and extraction force : 3-30N
- life test : 5,000 cycles

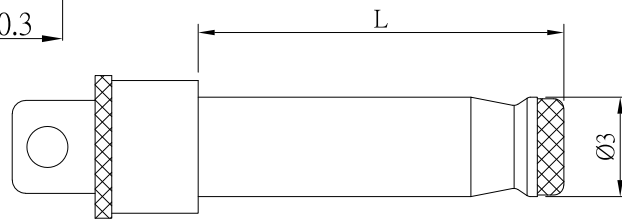

RECOMMENDED PLUG

NO.	DESCRIPTION	QTY	MATERIAL	PLATING
⑤	CONTACT FOOT	1	BRASS	Ag-Plating
④	PIN	1	BRASS	Ag-Plating
③	SPRING	1	PHOSPHOR BRONZE	Ag-Plating
②	CURVE PIECE	1	BRASS	Ag-Plating
①	HOUSING	1	PA9T	

東莞市高迪電子有限公司
DONG GUAN GAO DI ELECTRONICS CO., LTD

TOLERANCE UNLESS OTHERWISE STATED :
 Up to 5 ±0.2
 Above 5 ~ 15 ±0.3
 Above 15 ~ 30 ±0.4
 Above 30 ~ 50 ±0.5
 Angle ±0.3°

3RD. ANGEL'S UNITS MM

DRAWN BY:	DATE	MAT'L	TITLE	JACK
Jack Lu	08/28/24			
CHECKED BY:	DATE	FINISH	MODLE	DC JACK
Jacky Chen	08/28/24			
APPROVED BY:	DATE	SCALE	DWG NO.	DC-067DS-1.0-S124
Tony Kao	08/28/24	1 : 1		
SHEET NO.	1 of 1	PART NO.	DC-067DS-1.0-S124	
				SIZE A4
				VER R1

1	更新圖面	Jack	082824
ITEM NO.	DESCRIPTION	DRAWN	DATE