

PCB Layout (Pattern Side)

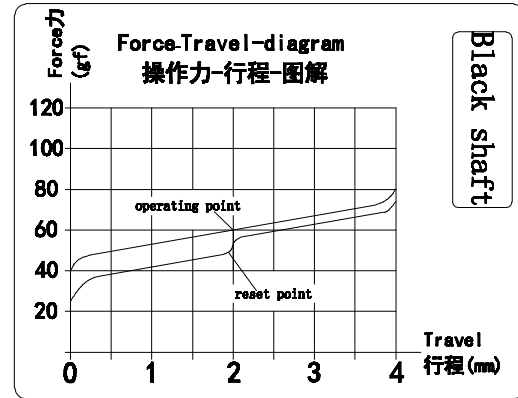

- Specification :**
1. Rating :12 VAC/DC max. 2 VDC min. 10mA AC/DC max. 10  $\mu$ A DC min.
  2. Contact Resistance : 200m $\Omega$  Max
  3. Insulation Resistance :100M $\Omega$  Min (DC100V)
  4. Withstand Voltage :AC500V (50-60Hz) for 1 minute
  5. Bounce Time:  $\leq$ 5msec (at 16 in/sec. actuation speed)
  6. Operation Force :60 $\pm$ 15gf
  7. End Force :80 $\pm$ 15gf
  8. Pretravel:2.0 $\pm$ 0.4mm
  9. Total travel:4.0 -0.3mm
  10. Operating Life :50,000,000 Cycles(min)

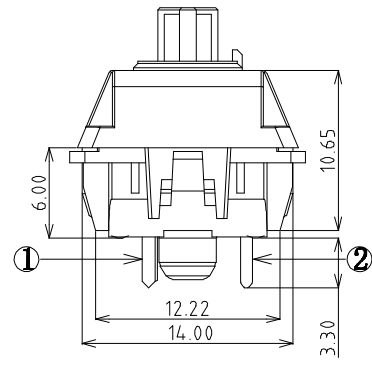
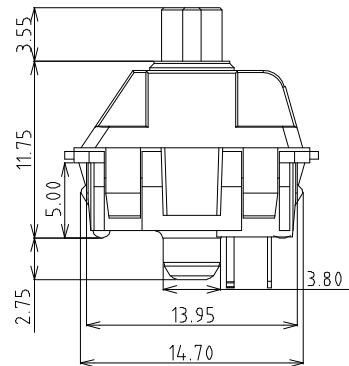
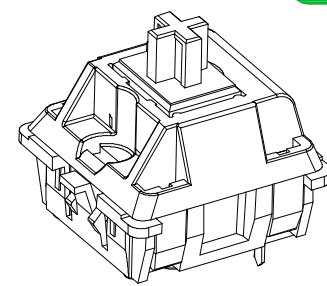
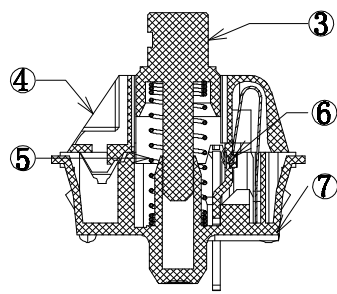
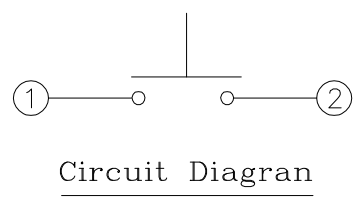
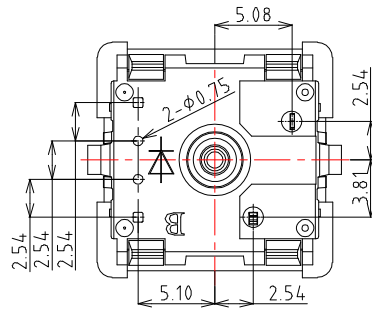

Circuit Diagram

7	Base	1	Nylon	Black		
6	contact	2	Silver alloy	Brushing Gold		
5	Spring	1	Stainless Steel			
4	Cover	1	Nylon	Black		
3	Keystroke	1	POM	Black(Black3C)		
2	Terminal	1	Brass	Plating Nickel		
1	Reed	1	Copper Alloy			
ITEM	PART NAME	TER'NO.	QTY.	MATERIAL	FINISHING	REMARK

东莞市高迪电子有限公司  
DONG GUAN GAO DI ELECTRONICS CO., LTD

TOLERANCE UNLESS OTHERWISE STATED :  
Up to 5  $\pm$ 0.2  
Above 5 ~ 15  $\pm$ 0.3  
Above 15 ~ 30  $\pm$ 0.4  
Above 30 ~ 50  $\pm$ 0.5  
Angle  $\pm$ 0.3

3RD. ANGEL'S

UNITS MM

DRAWN BY:	DATE	MAT'L	TITLE	SWITCH
Jack Lu	12/16/15			
CHECKED BY:	DATE	FINISH	MODLE	Keyboard Switch / Black Shaft
Jacky Chen	12/16/15			
APPROVED BY:	DATE	SCALE	DWG NO.	KS-01B-60-S105
Tony Kao	12/16/15	1 : 1		
		SHEET NO.	PART NO.	KS-01B-60-S105
		1 of 1		
				SIZE A4
				VER R

ITEM NO.	DESCRIPTION	DRAWN	DATE