

REV.	ECN NO.	DESCRIPTION	DESIGN	DATE
A		INITIAL	Lucky	2018.03.22

NOTES:

- CONTACT CURRENT RATING: 1A.
- CONTACT RESISTANCE: 50 mΩ MAX.;
- INSULATION RESISTANCE: 1000Ω MIN.;
- DIELECTRIC WITHSTANDING: 500V AC MIN.;
- DURABILITY: 5,000 CYCLES MIN.;
- CONNECTOR MATING FORCES: 29.4N (3.00KgF) MAX.;
- CONNECTOR UNMATING FORCES: 2.94N(0.30KgF) MIN.;
- PRODUCT MEET THE REQUEST OF THE RoHs, SEE TABLE A:

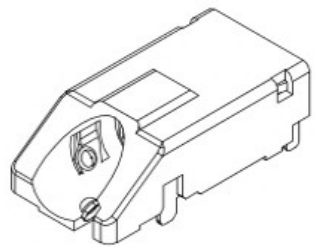
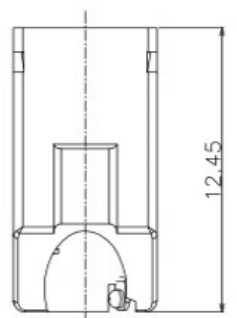

3D VIEW

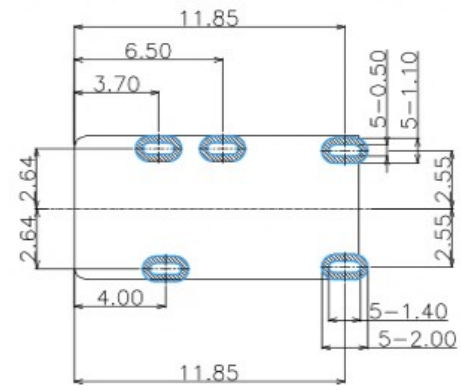
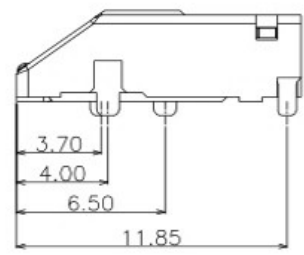
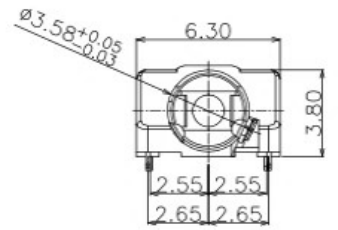

RECOMMEND FPC LAYOUT  
TOLERANCE :±0.05

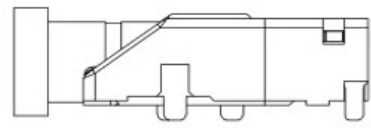
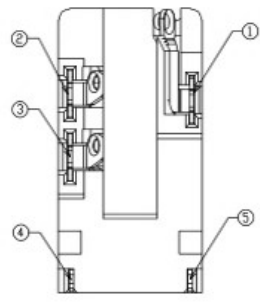

PLUG MATE DRAWING

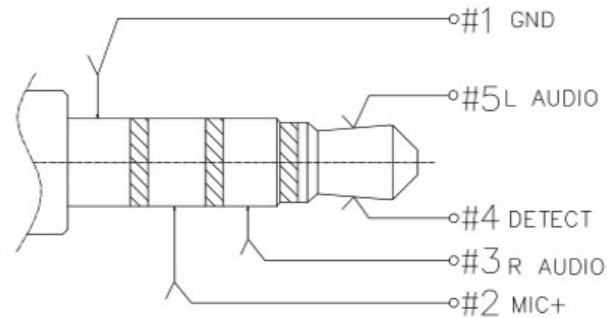

MALE PLUG SCHEMATIC

ITEM	PART NAME	Q'TY	MATERIAL	REMARK
⑤	HOUSING	1	PA9T COLOR BLACK	
④	CONTACT 4#	1	STAINLESS STEEL; NICKEL(40u"MIN.) UNDER PLATING OVERALL,GOLD FLASH PLATING ON SOLDER AREA ;GOLD FLASH PLATING ON CONTACT AREA	T=0.2
③	CONTACT 3#	1	STAINLESS STEEL; NICKEL(40u"MIN.) UNDER PLATING OVERALL,GOLD FLASH PLATING ON SOLDER AREA ;GOLD FLASH PLATING ON CONTACT AREA	T=0.2
②	CONTACT 2#	1	PHORPHOS BRONZE; NICKEL(40u"MIN.) UNDER PLATING OVERALL,GOLD FLASH PLATING ON SOLDER AREA ;GOLD FLASH PLATING ON CONTACT AREA	T=0.2
①	CONTACT 1#	1	PHORPHOS BRONZE; NICKEL(40u"MIN.) UNDER PLATING OVERALL,GOLD FLASH PLATING ON SOLDER AREA ;GOLD FLASH PLATING ON CONTACT AREA	T=0.2

UNLESS OTHERWISE SPECIFIED TOLERANCES

DECIMALS:		ANGLES:	
DIM	TOL	DIM	TOL
x.	±0.50	x.	±2'
x.x	±0.30	x.x	±1'
x.xx	±0.20	x.xx	—
x.xxx	±0.10	x.xxx	—

东莞市高迪电子有限公司

DWG NO.		PART NAME:	PHONE JACK
DESIGN:		PART NO.	
CHECK:		REV.	A
APPROVED		UNIT:	mm
		SHEET:	1/1

由 Autodesk 教育版产品制作

由 Autodesk 教育版产品制作