

线路图  
CIRCUIT DIAGRAM

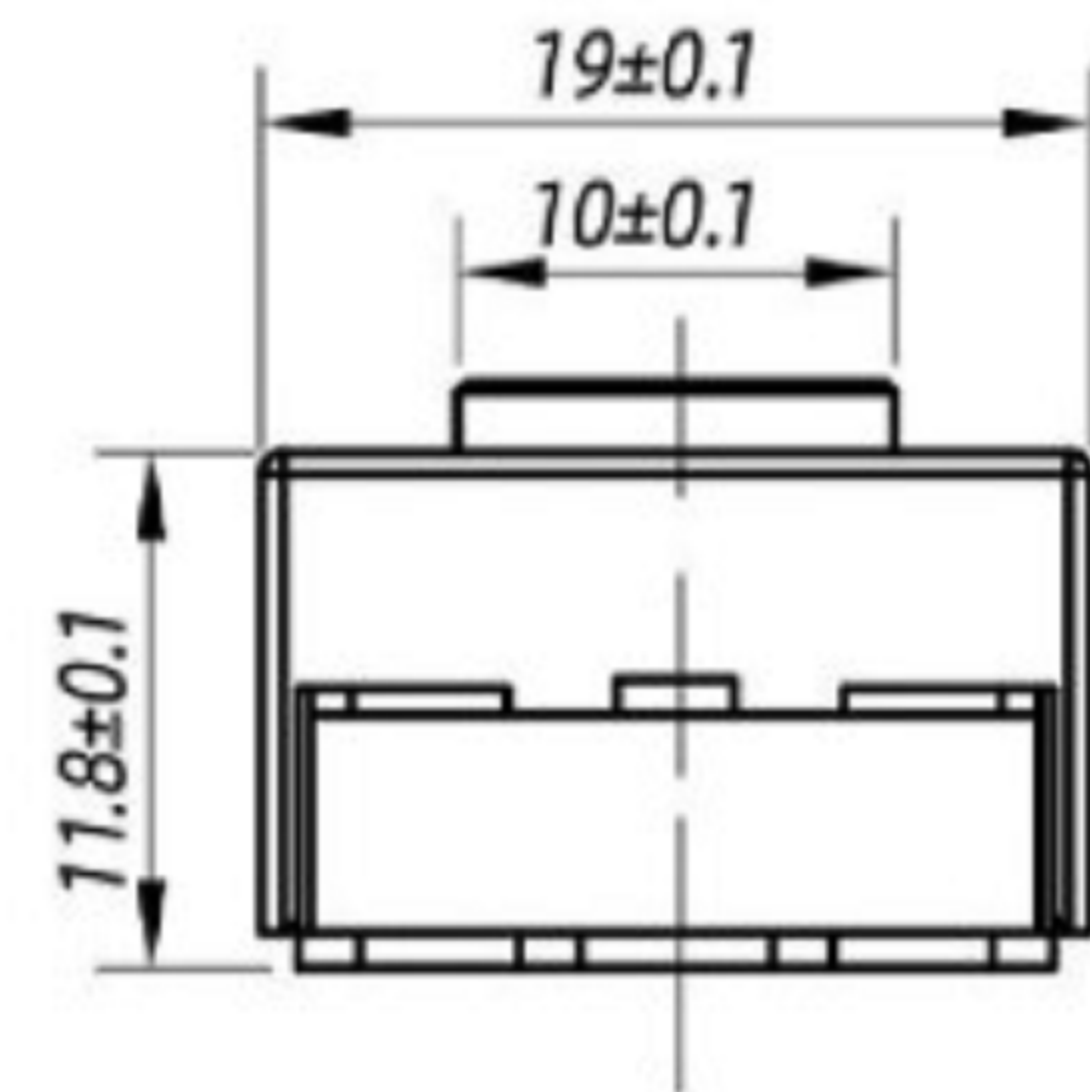
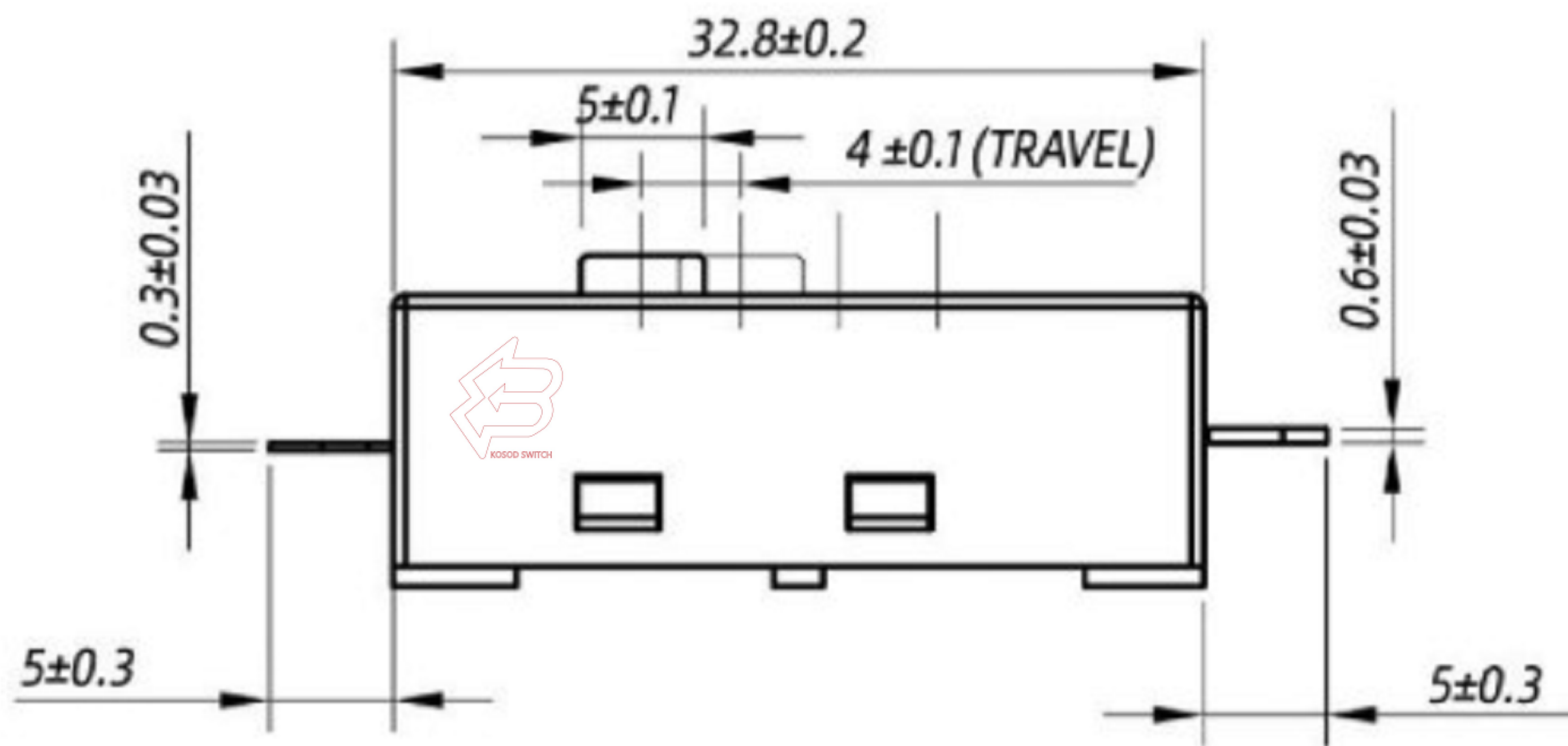
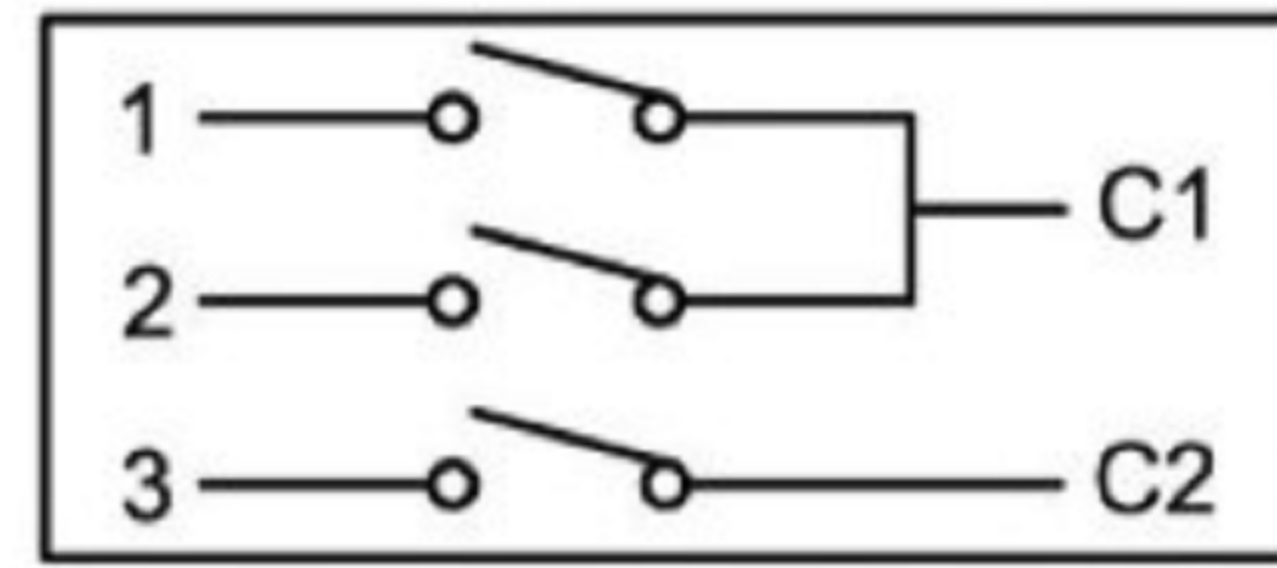

电流电路  
CURRENT CIRCUIT

CIRCUIT:011

位置 POSITION	电路 CIRCUIT
1 (INITIAL) 起始	OFF
2	C1+1
3	C1+1+2
4	C1+1+2, C2+3

四档滑动开关

- 滑动开关型号 SLIDE SWITCH MODEL: KND-2-1AS011
- 焊线端子 SOLDER CONNECTOR TYPE; 双刀四掷, 多回路 DOUBLE POLE FOUR THROW, MULTI-CIRCUIT
- 额定值 RATING: ▲ 16(4)A 125/250VAC  $\mu$ T105  
10(2)A 125/250VAC  $\mu$ T105
- 接触电阻 CONTACT RESISTANCE: <50m $\Omega$  (INITIAL)
- 绝缘电阻 INSULATION RESISTANCE:  $\geq$ 100M $\Omega$ (DC500V/1MIN)
- 介电强度 DIELECTRIC STRENGTH: 1500V /5mA /1MIN
- 机械寿命 MECHANICAL LIFE: >50000 CYCLES
- 电气寿命 ELECTRICAL LIFE: >10000 CYCLES
- 端子手工焊接条件 SOLDER ABILITY OF TERMINAL: MAX260°C, 3S
- 操作力 OPERATION FORCE: 550 $\pm$ 150gf
- 所有部件均使用环保材料 ALL MATERIALS ARE RoHS COMPLIANT

▲ 16(4)A 125/250VAC  $\mu$ T105  
10(2)A 125/250VAC  $\mu$ T85

NO.	PARTS	MATERIALS	QTY	FINISH
5	CONTACT CLIP	PBS STRIP	1	Ag PLATED
4	TERMINAL	BRASS	3	Ag PLATED
3	BASE	PHENOLIC RESIN	1	NATURAL
2	FRAME	STEEL STRIP	1	Ni PLATED
1	KNOB	POM	1	BLACK

东莞市高迪电子有限公司  
DONG GUAN GAO DI ELECTRONICS CO., LTD

ITEM NO.	DESCRIPTION	DRAWN	DATE
2	新增SPEC	Jack	111914
1	新增尺寸	Jack	061614

TOLERANCE UNLESS OTHERWISE STATED: Up to 5  $\pm$ 0.2, Above 5 ~ 15  $\pm$ 0.3, Above 15 ~ 30  $\pm$ 0.4, Above 30 ~ 50  $\pm$ 0.5, Angle  $\pm$ 0.3°

3RD. ANGEL'S UNITS MM

DRAWN BY: Ming Ming Zou	DATE: 11/19/14	MAT'L	TITLE: SWITCH
CHECKED BY: Ning Ning Su	DATE: 11/19/14	FINISH	MODLE: SLIDE SWITCH
APPROVED BY: Jia Xiang	DATE: 11/19/14	SCALE: 1:1	DWG NO.: GD-KND-2-A1S011
SHEET NO. 1 of 1		PART NO.	SIZE: A4
			VER: R2