

## DB-14 SERIES

額定電流、電壓 RATING

5A 250VAC T105 UL cUL

2.5A 250VAC ENEC VDE CCC KC

規格標準 STANDARD

IEC 60320 C6

絕緣電阻 INSULATION RESISTANCE

100MΩ 500V DC/1 MIN

介電強度 DIELECTRIC INTENSITY

2500VAC/5S

材質防火 MATERIAL

94V-2~V-0



東莞市高迪電子有限公司  
DONG GUAN GAO DI ELECTRONICS CO., LTD

TOLERANCE UNLESS  
OTHERWISE STATED :

Up to 5 ±0.2  
Above 5 ~ 15 ±0.3  
Above 15 ~ 30 ±0.4  
Above 30 ~ 50 ±0.5  
Angle ±0.3°

3RD.  
ANGEL'S

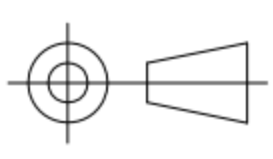

UNITS

MM

DRAWN BY: DATE  
Ming Ming Zou 10/31/13

CHECKED BY: DATE  
Ning Ning Su 10/31/13

APPROVED BY: DATE  
Jia Xiang 10/31/13

MAT'L

FINISH

SCALE

SHEET NO.

TITLE SWITCH

MODLE AC POWER SOCKET

DWG NO. **GD-DB-5D11**

PART NO.

SIZE  
A4  
VER  
R

ITEM NO.	DESCRIPTION	DRAWN	DATE