

SCHEMATIC

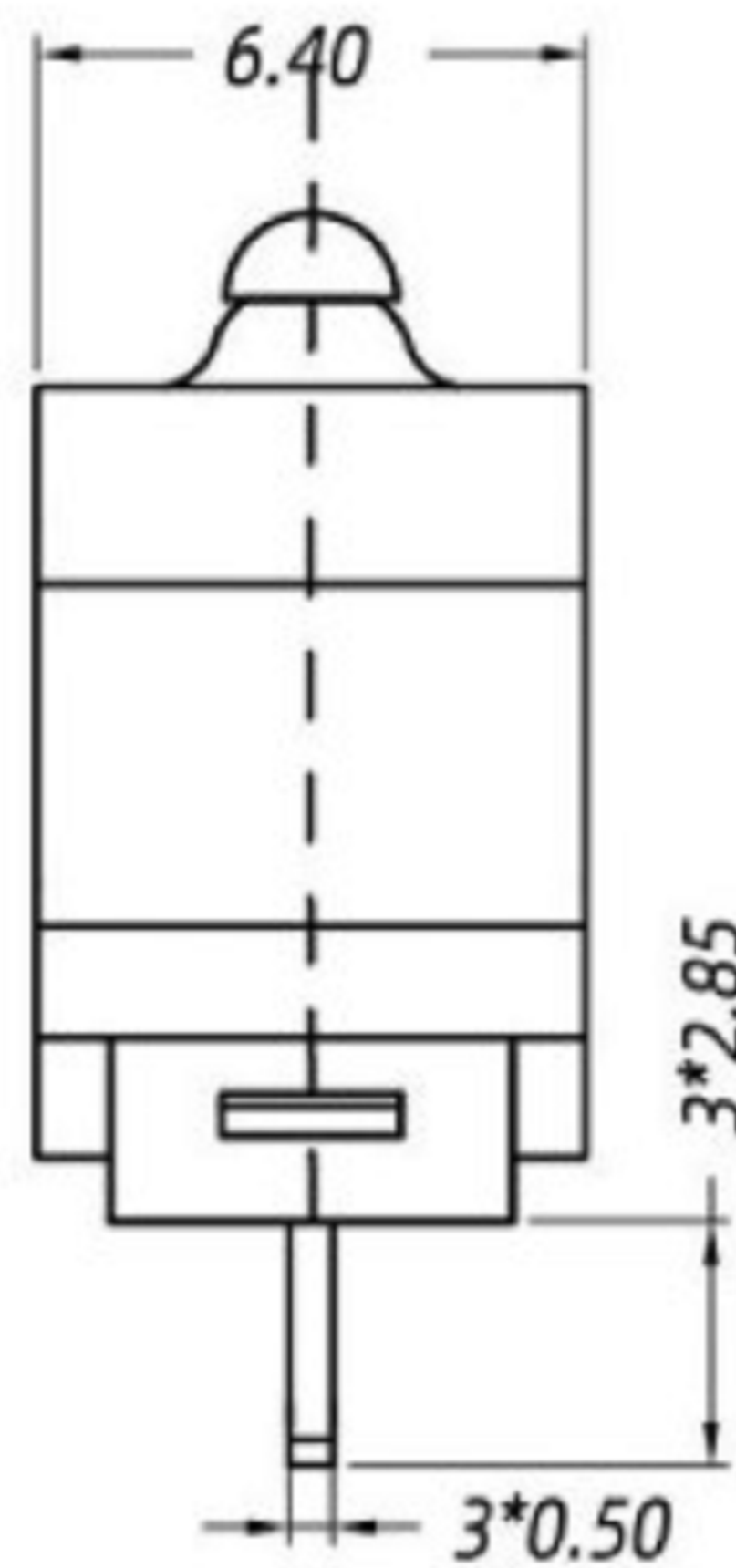
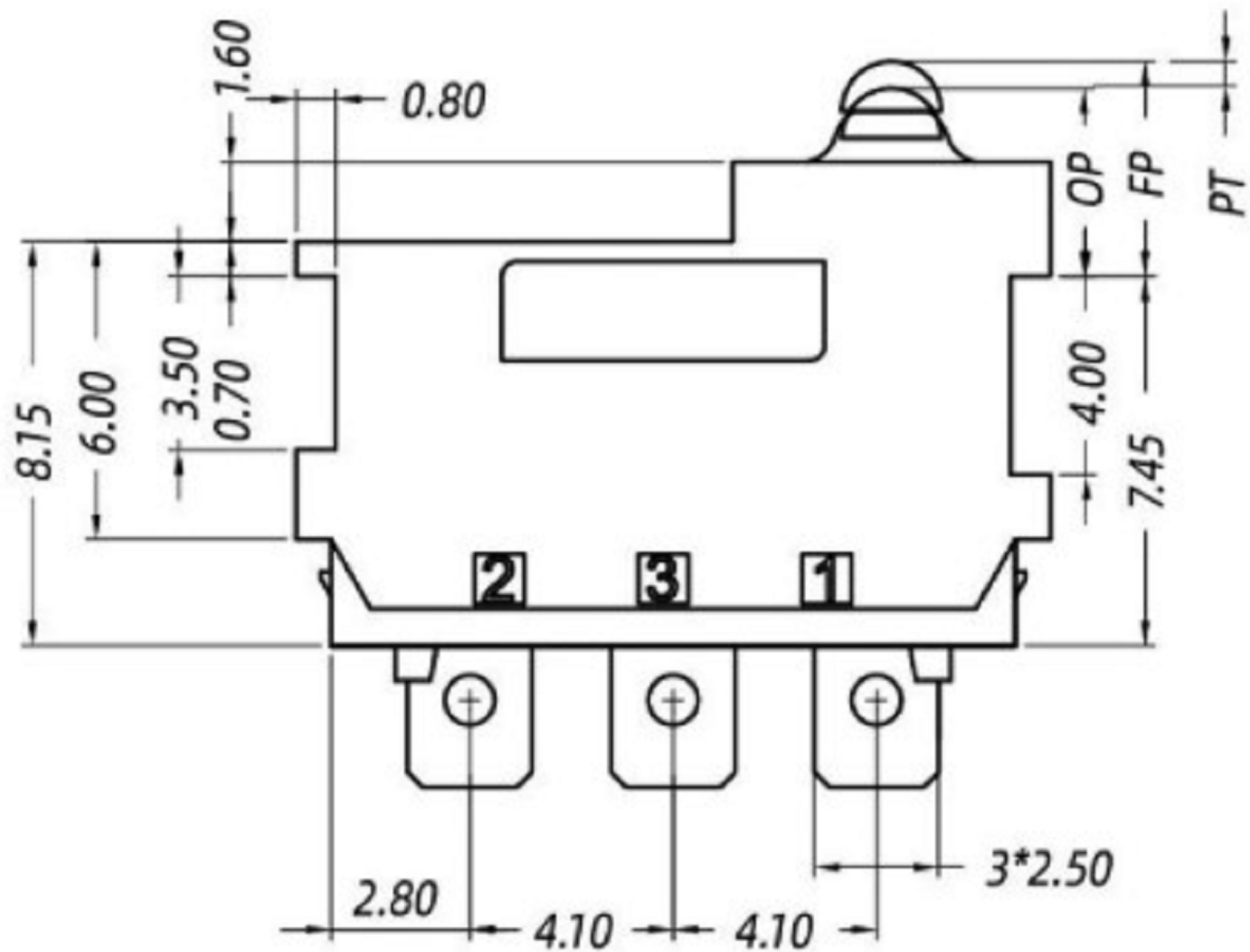
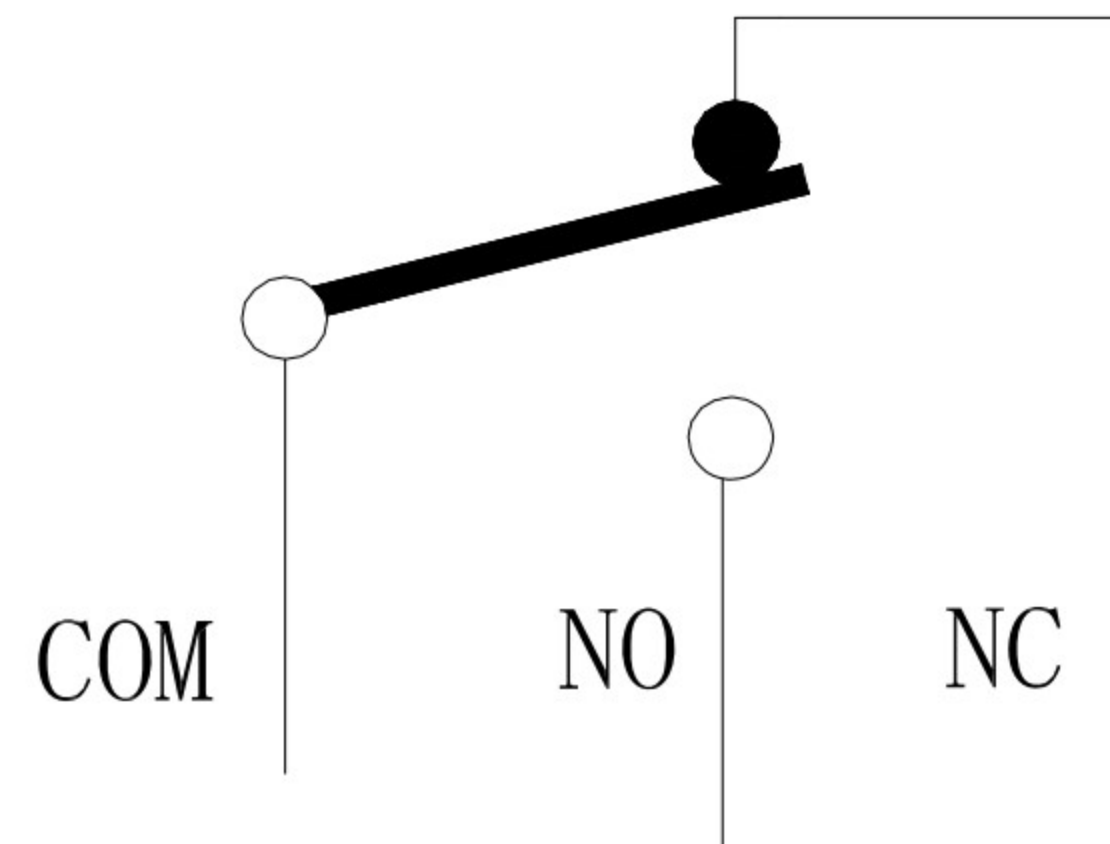

防水微动开关

- 1.微动开关型号 MICRO SWITCH MODEL: LXW-3-6-5C
- 2.焊线端子 SOLDER CONNECTOR TYPE;
单刀单掷 SINGLE POLE SINGLE THROW
- 3.额定值 RATING: ▲3A 125VAC μ 25T85
1A 125VAC μ 25T85
0.1A 125VAC μ 25T85
3A 12/24/30/48VDC μ 25T85
1A 12/24/30/48VDC μ 25T85
0.1A 12/24/30/48VDC μ 25T85
- 4.接触电阻 CONTACT RESISTANCE: <math>< 50\text{m}\Omega</math> (INITIAL)
- 5.绝缘电阻 INSULATION RESISTANCE: $\geq 100\text{M}\Omega$ (DC500V/1MIN)
- 6.介电强度 DIELECTRIC STRENGTH: 1500V /5mA /1MIN
- 7.机械寿命 MECHANICAL LIFE: >100000 CYCLES
- 8.电气寿命 ELECTRICAL LIFE: >10000 CYCLES
- 9.端子手工焊接条件 SOLDER ABILITY OF TERMINAL: MAX260°C, 3S
- 10.操作力 OPERATION FORCE: 100 \pm 50gf
- 11.所有部件均使用环保材料 ALL MATERIALS ARE RoHS COMPLIANT

东莞市高迪电子有限公司
DONG GUAN GAO DI ELECTRONICS CO., LTD

TOLERANCE UNLESS OTHERWISE STATED:
Up to 5 ± 0.2
Above 5 ~ 15 ± 0.3
Above 15 ~ 30 ± 0.4
Above 30 ~ 50 ± 0.5
Angle $\pm 0.3^\circ$

3RD. ANGEL'S

UNITS MM

DRAWN BY: DATE
Ming Ming Zou 10/31/13

CHECKED BY: DATE
Ning Ning Su 10/31/13

APPROVED BY: DATE
Jia Xiang 10/31/13

MAT'L		TITLE	SWITCH
FINISH		MODLE	MICRO SWITCH
SCALE	1:1	DWG NO.	GD-LXW-3-6-5C-AA
SHEET NO.	1 of 1	PART NO.	
			SIZE A4
			VER R

ITEM NO.	DESCRIPTION	DRAWN	DATE