

REV	DESCRIPTION	DESIGN	DATE
A	NEW RELEASE	Lingqing	2021/03/17

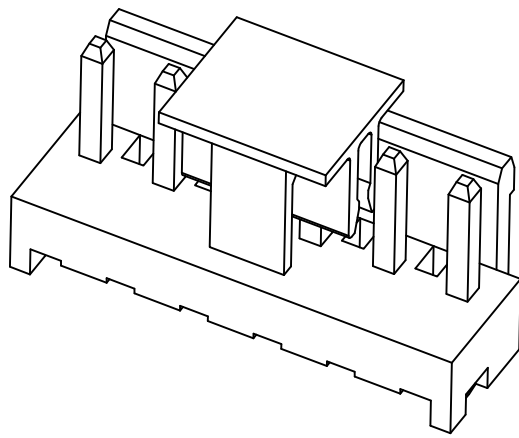

Specifications:
 Contact resistance: $\leq 20m\Omega$
 Insulation resistance: $\geq 1000M\Omega$
 Rated voltage: 250V AC DC
 Rated current: 7.0A AC DC
 Withstand Voltage: 1000V AC/minute
 Temperature Range: $-40^{\circ}C \sim +105^{\circ}C$
 Housing: LCP UL94V-0, Natural
 CAP: LCP UL94V-0, Natural
 Contacts: Brass Sn-plated

Circuits	Dimensions (mm)		
	A	B	C
02	3.96	7.92	5.32
03	7.92	11.88	9.28
04	11.88	15.84	13.24
05	15.84	19.80	17.20
06	19.80	23.76	21.16
07	23.76	27.72	25.12
08	27.72	31.68	29.08

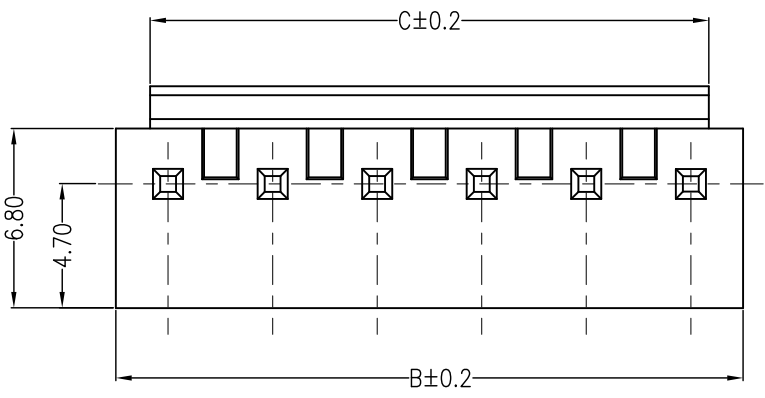
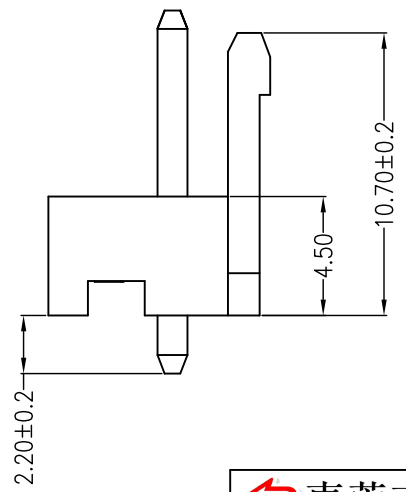
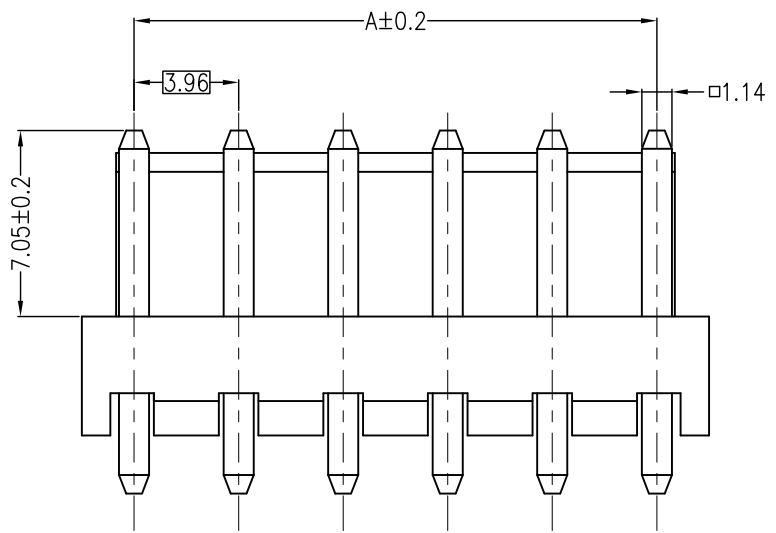

ORDER INFORMATION:

T3966A-**-F2MA2-R-X

PART No. _____
 No.OF CIRCUITS: _____
 PLASTIC MATERIAL: _____
 F2M=LCP(BEIGE)

CAP _____
 PACKAGING: _____
 R=REEL _____
 P=PE _____
 Metal code: _____
 2=Brass _____
 PLATING: _____
 A=Sn _____

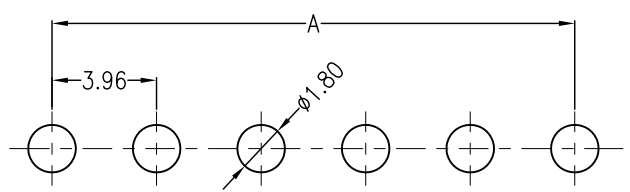

東莞市高迪電子有限公司
 DONG GUAN GAO DI ELECTRONICS CO., LTD

TITLE: 3.96 Pitch Wafer 180° SMT

GENERAL TOLERANCE		USE:	PART NO.:
X. ± 0.50	X. $\pm 5^{\circ}$	CUSTOMER	T3966A-**-F2MA2-R-X
X.X ± 0.30	X.X $\pm 2^{\circ}$	APPD: Shaojinghe	DWG NO.:
X.XX ± 0.20	X.XX $\pm 1^{\circ}$	CHKD: Fangsongle	GCKH-0909
UNITS: mm		DR: Zenglingqing	SCALE: 1 : 1
			SHEET: 1 / 1

REV	DESCRIPTION	DESIGN	DATE
A	NEW RELEASE	Lingqing	2021/03/17

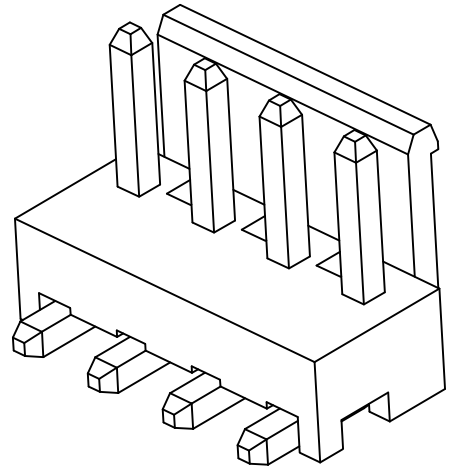
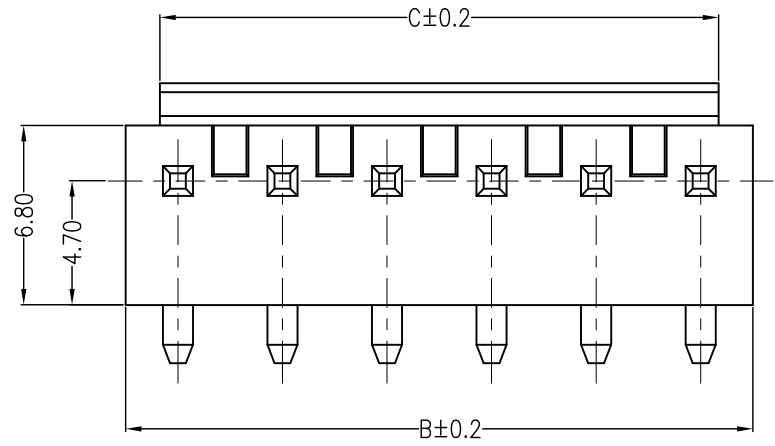

Specifications:
 Contact resistance: ≤20mΩ
 Insulation resistance: ≥1000MΩ
 Rated voltage: 250V AC DC
 Rated current: 7.0A AC DC
 Withstand Voltage: 1000V AC/minute
 Temperature Range: -40°C ~ +105°C
 Housing: LCP UL94V-0, Natural
 Contacts: Brass /Sn

Circuits	Dimensions (mm)		
	A	B	C
02	3.96	7.92	5.32
03	7.92	11.88	9.28
04	11.88	15.84	13.24
05	15.84	19.80	17.20
06	19.80	23.76	21.16
07	23.76	27.72	25.12
08	27.72	31.68	29.08

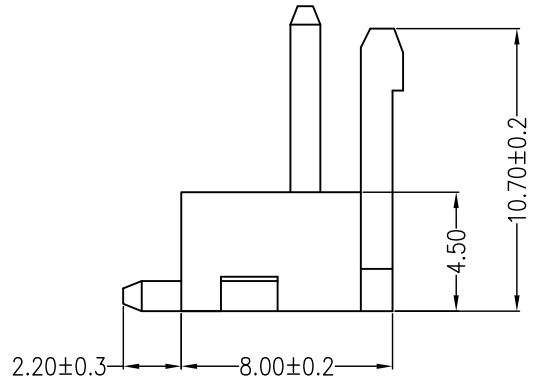
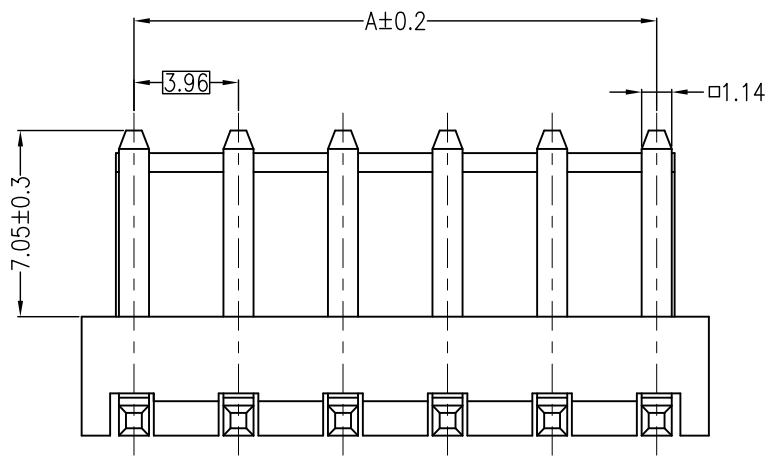

ORDER INFORMATION:

T3966AW-**-F2MA2-R

PART No. _____
 No.OF CIRCUITS: _____
 PLASTIC MATERIAL: _____
 F2M=LCP(BEIGE)

PACKAGING:
 R=REEL
 P=PE
 Metal code:
 2=Brass
 PLATING:
 A=Sn

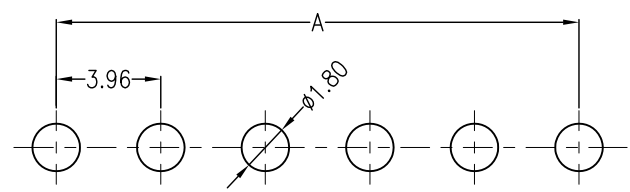

RECOMMENDED PCB LAYOUT(TOP VIEW)
 TOLERANCE: ±0.05mm

東莞市高迪電子有限公司 DONG GUAN GAO DI ELECTRONICS CO., LTD		TITLE: 3.96 Pitch Wafer 180° SMT	
		PART NO.: T3966AW-**-F2MA2-R	
GENERAL TOLERANCE		USE: CUSTOMER	
X. ±0.50	X. ±5°	APPD: Shaojinghe	
X.X ±0.30	X.X ±2°	CHKD: Fangsongle	
X.XX ±0.20	X.XX ±1°	DR: Zenglingqing	
UNITS: mm		SCALE 1 : 1	SHEET 1 / 1

REV	ECN No.	DESCRIPTION	DESIGN	DATE
A		Release	程永海	2022.08.31

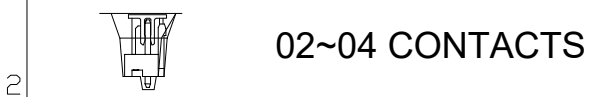
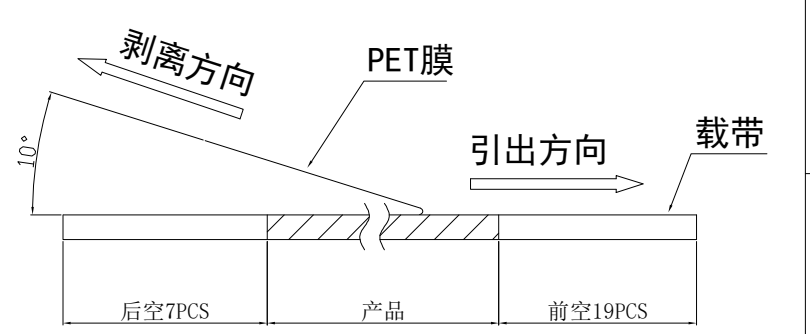
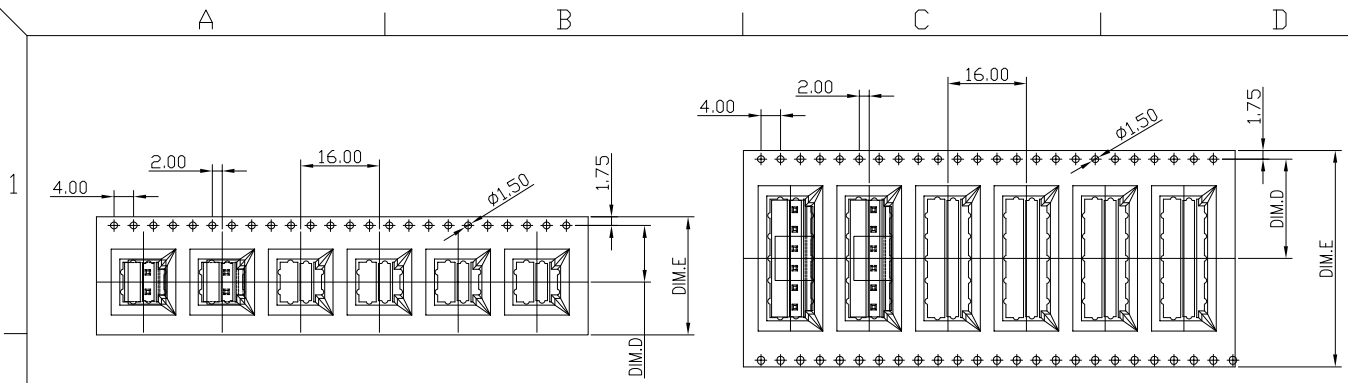

05~06 CONTACTS

(PET膜剥离示意图)

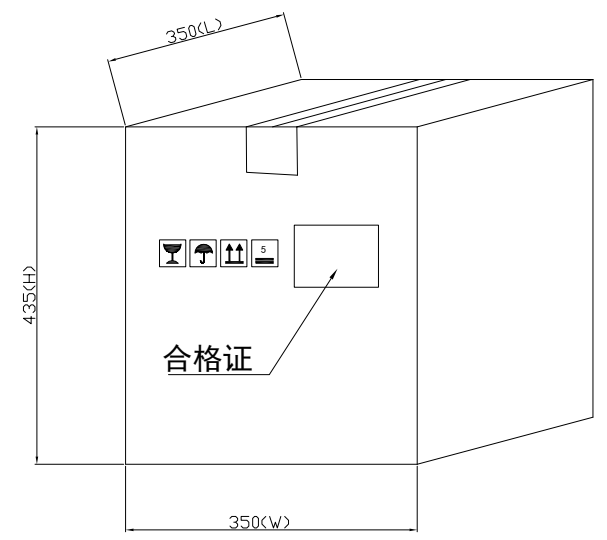
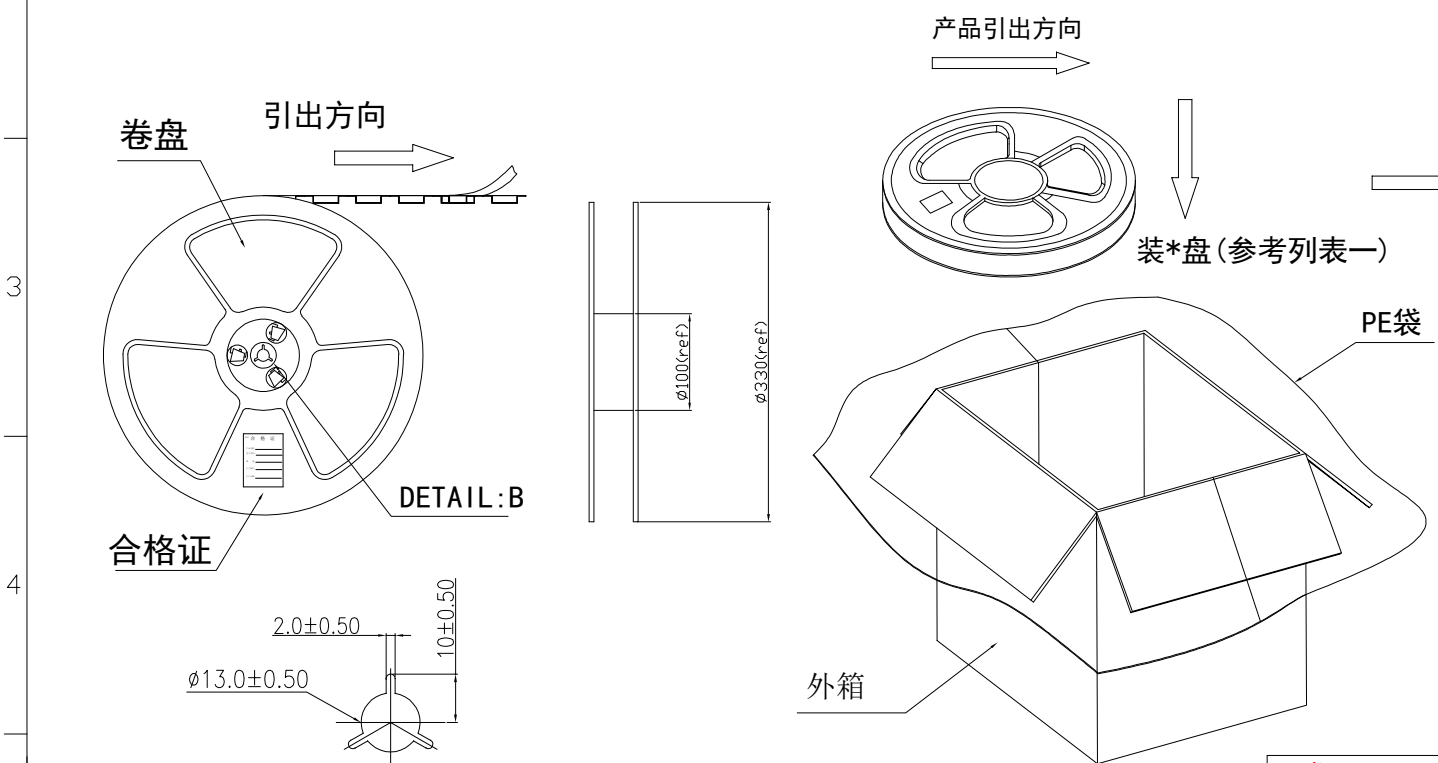

列表一

Circuits	DIM. D	DIM. E	Q'ty/Reel	Packing (Reel/Caton)
02-03PIN	11.5	24	250PCS	15/Reel
04PIN	14.25	32	250PCS	11/Reel
05-06PIN	20.2	44	250PCS	8/Reel

- 包装说明:
- 把成品包入卷盘中, 每盘装250PCS, 卷盘上贴上合格证, 将装好产品的卷盘放进外箱中, 外箱内先套一个大PE袋, 外箱上贴贴上合格证.
 - 所有材料有害物控制需符合RoHS标准.

东莞市高迪电子有限公司
DONG GUAN GAO DI ELECTRONICS CO., LTD

X.± 0.5	X.±'	USE: MANUFACTURE
.X± 0.3	.X±'	
.XX± 0.25	.XX±'	APPD: 朱志剛
--	--	CHKD: 蒋建银
		UNITS: mm
		DR: 程永海

TITLE: T3966A	
PART NO.: T3966A包装规范	
DWG NO.: GCKH-0909	
SCALE 1 : 1	SHEET 1 / 1

REV	ECN No.	DESCRIPTION	DESIGN	DATE
A		Release	程永海	2023.02.24

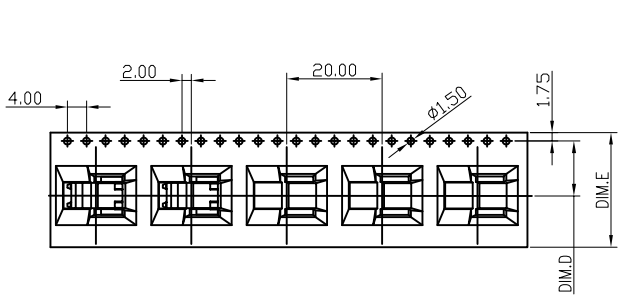

02~03 CONTACTS

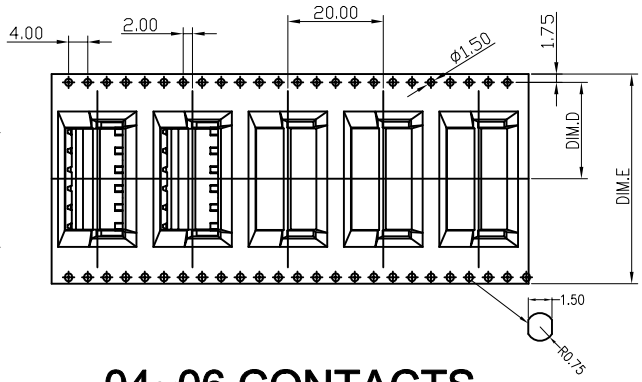

04~06 CONTACTS

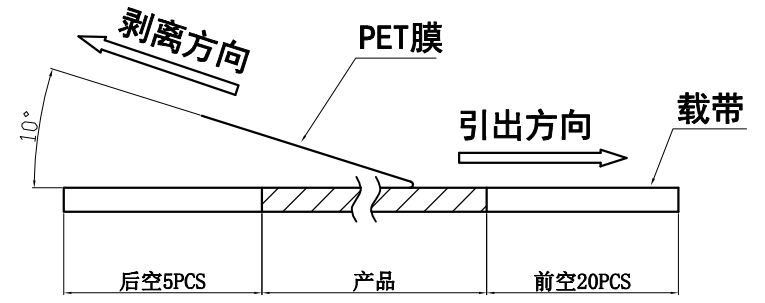

(PET膜剥离示意图)

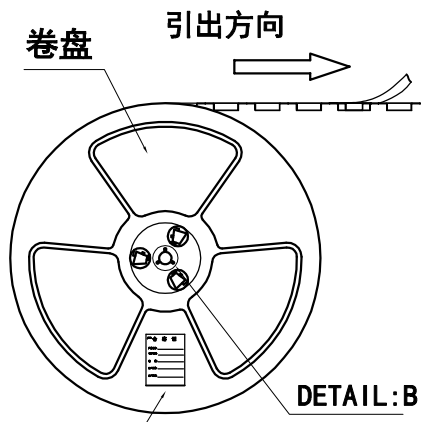

合格证

DETAIL:B

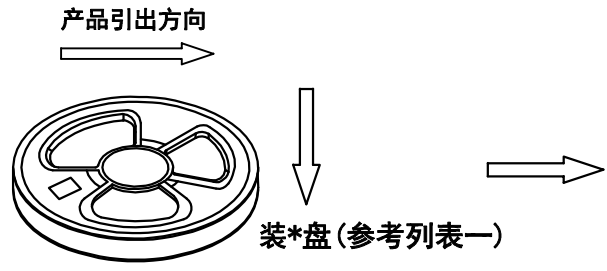

装*盘 (参考列表一)

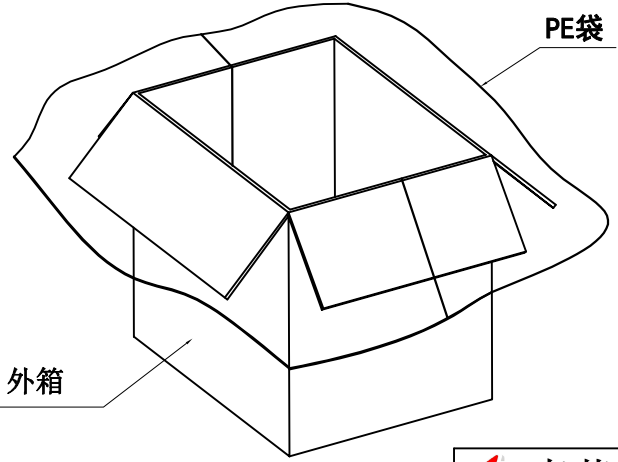

外箱

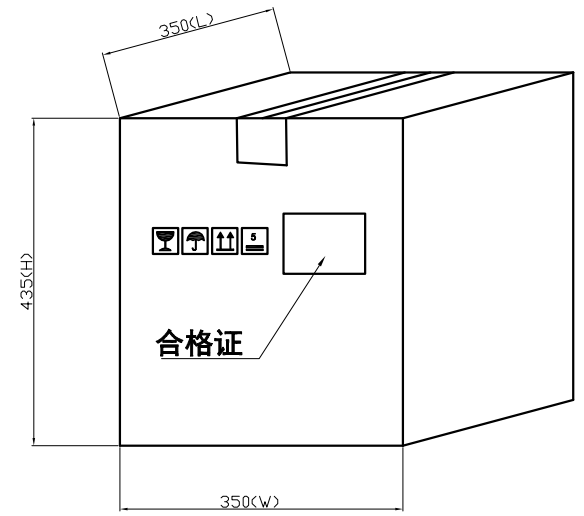

合格证

列表一

Circuits	DIM. D	DIM. E	Q'ty/Reel	Packing (Reel/Caton)
02-03PIN	11.5	24	250PCS	15/Reel
04PIN	14.25	32	250PCS	11/Reel
05-06PIN	20.2	44	250PCS	8/Reel

包装说明:

- 把成品包入卷盘中, 每盘装250PCS, 卷盘上贴上合格证, 将装好产品的卷盘放进外箱中, 外箱内先套一个大PE袋, 外箱上贴贴上合格证。
- 所有材料有害物控制需符合RoHS标准。

东莞市高迪电子有限公司
DONG GUAN GAO DI ELECTRONICS CO., LTD

X.± 0.5	X.±'	USE: MANUFACTURE
.X± 0.3	.X±'	APPD: 朱志刚
.XX±0.25	.XX±'	CHKD: 蒋建银
--	--	DR: 程永海
	UNITS: mm	

TITLE: T3966AW
PART NO.: T3966AW包装规范
DWG NO.: GCKH-0973
SCALE: 1 : 1
SHEET: 1 / 1