

REV	DESCRIPTION	DESIGN	DATE
A	NEW RELEASE	Lingqing	2020/12/03

Specifications:  
 Contact resistance:  $\leq 30m\Omega$   
 Insulation resistance:  $\geq 1000M\Omega$   
 Rated voltage: 250V AC DC  
 Rated current: 3.0A AC DC  
 Withstand Voltage: 800V AC/minute  
 Temperature Range:  $-25^{\circ}C \sim +85^{\circ}C$   
 Housing: LCP UL94V-0, Natural  
 Contacts: Brass Sn-plated

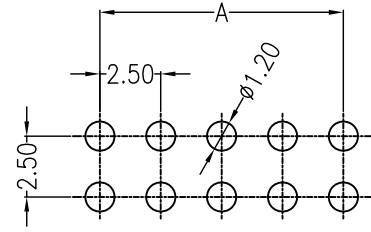

RECOMMENDED PCB LAYOUT(TOP VIEW)  
 TOLERANCE:  $\pm 0.05mm$

Circuits	Dimensions (mm)		
	A	B	C
202 (2X2)	2.50	5.70	7.50
203 (2X3)	5.00	8.20	10.00
204 (2X4)	7.50	10.70	12.50
205 (2X5)	10.00	13.20	15.00
206 (2X6)	12.50	15.70	17.50
207 (2X7)	15.00	18.20	20.00
208 (2X8)	17.50	20.70	22.50
209 (2X9)	20.00	23.20	25.00
210 (2X10)	22.50	25.70	27.50
211 (2X11)	25.00	28.20	30.00
212 (2X12)	27.50	30.70	32.50

ORDER INFORMATION:  
 T2508A-2\*\*-F1CA2-R-X

PART No. \_\_\_\_\_  
 No.OF CIRCUITS: \_\_\_\_\_  
 2\*2~2\*12  
 PLASTIC MATERIAL: \_\_\_\_\_  
 F1C=LCP(Natural)

Special code  
 X=Cap  
 PACKAGING:  
 R=REEL  
 Metal code:  
 2=Brass  
 PLATING:  
 A=Sn-plated

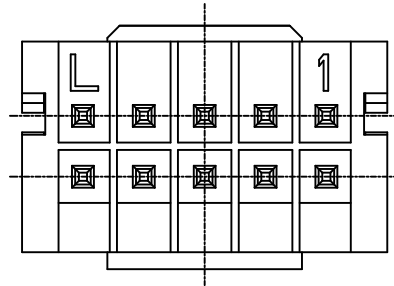

**東莞市高迪電子有限公司**  
 DONG GUAN GAO DI ELECTRONICS CO., LTD

TITLE: 2.5mm pitch 180°Wafe DIP type

GENERAL TOLERANCE

X. $\pm 0.50$	X. $\pm 5^{\circ}$
X.X $\pm 0.30$	X.X $\pm 2^{\circ}$
X.XX $\pm 0.20$	X.XX $\pm 1^{\circ}$

UNITS: mm

USE: CUSTOMER  
 APPD: Shaojinghe  
 CHKD: Fangsongle  
 DR: Zenglingqing

PART NO.: T2508A-2\*\*-F1CA2-R-X  
 DWG NO.: GCKH-0916  
 SCALE: 1 : 1  
 SHEET: 1 / 1

REV	DESCRIPTION	DESIGN	DATE
A	NEW RELEASE	Lingqing	2020/12/03

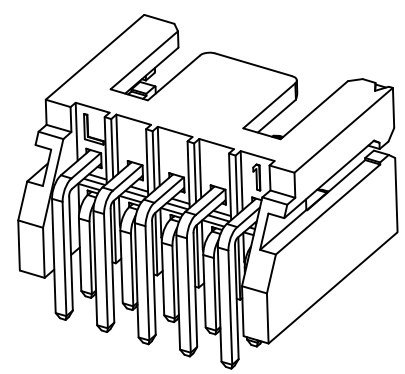
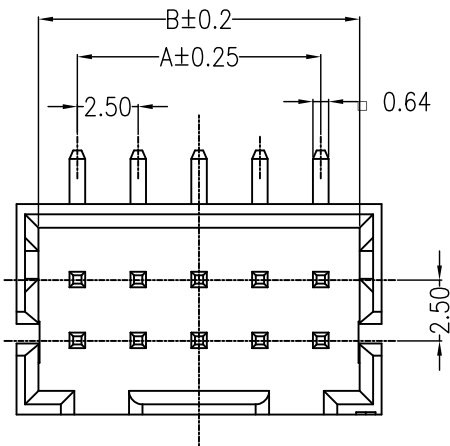

**Specifications:**

Contact resistance:  $\leq 30m\Omega$   
 Insulation resistance:  $\geq 1000M\Omega$   
 Rated voltage: 250V AC DC  
 Rated current: 3.0A AC DC  
 Withstand Voltage: 800V AC/minute  
 Temperature Range:  $-25^{\circ}C \sim +85^{\circ}C$   
 Housing: LCP UL94V-0, Natural  
 Contacts: Brass Sn-plated

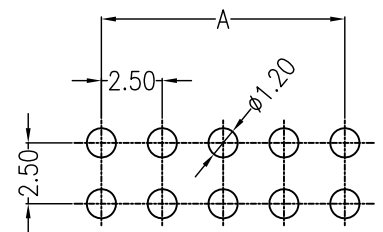
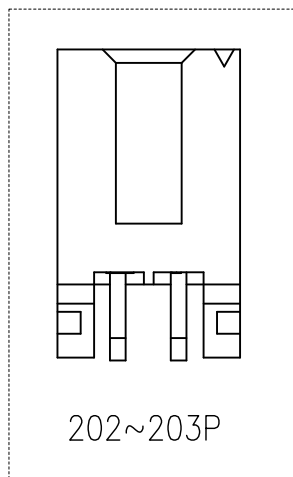
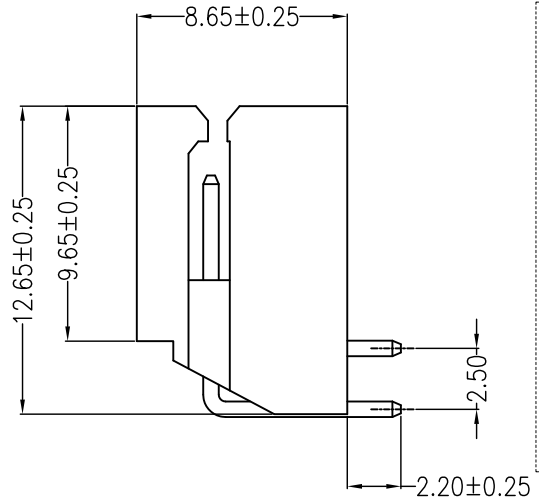
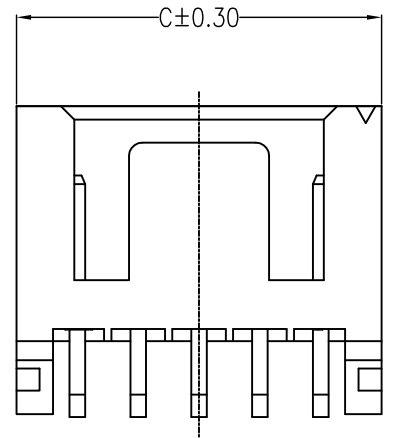

RECOMMENDED PCB LAYOUT(TOP VIEW)  
 TOLERANCE:  $\pm 0.05mm$

Circuits	Dimensions (mm)		
	A	B	C
202 (2X2)	2.50	5.70	7.50
203 (2X3)	5.00	8.20	10.00
204 (2X4)	7.50	10.70	12.50
205 (2X5)	10.00	13.20	15.00
206 (2X6)	12.50	15.70	17.50
207 (2X7)	15.00	18.20	20.00
208 (2X8)	17.50	20.70	22.50
209 (2X9)	20.00	23.20	25.00
210 (2X10)	22.50	25.70	27.50
211 (2X11)	25.00	28.20	30.00
212 (2X12)	27.50	30.70	32.50

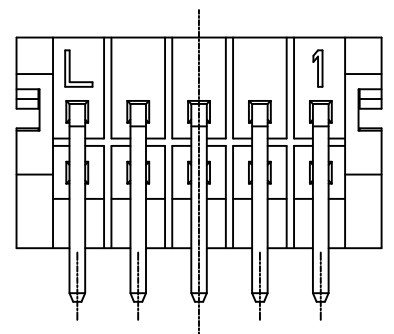

**ORDER INFORMATION:**

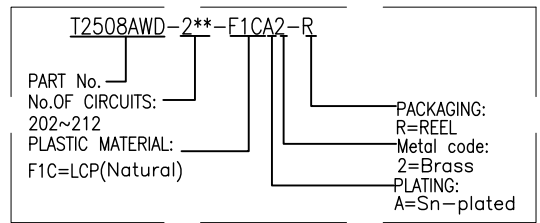

		<b>東莞市高迪電子有限公司</b> DONG GUAN GAO DI ELECTRONICS CO., LTD		TITLE: 2.5mm pitch 90°Wafe DIP type	
		GENERAL TOLERANCE X. $\pm 0.50$ X. $\pm 5^{\circ}$ X.X $\pm 0.30$ X.X $\pm 2^{\circ}$ X.XX $\pm 0.20$ X.XX $\pm 1^{\circ}$		USE: CUSTOMER APPD: Shaojinghe CHKD: Fangsongle	
UNITS: mm		DR: Zenglingqing		DWG NO.: GCKH-0917	
				SCALE 1 : 1	
				SHEET 1 / 1	