

A B C D

E F

REV	ECN No.	DESCRIPTION	DESIGN	DATE
A	-	Release	李润	2016.05.23

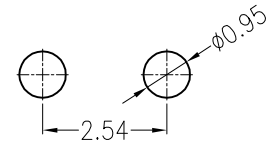
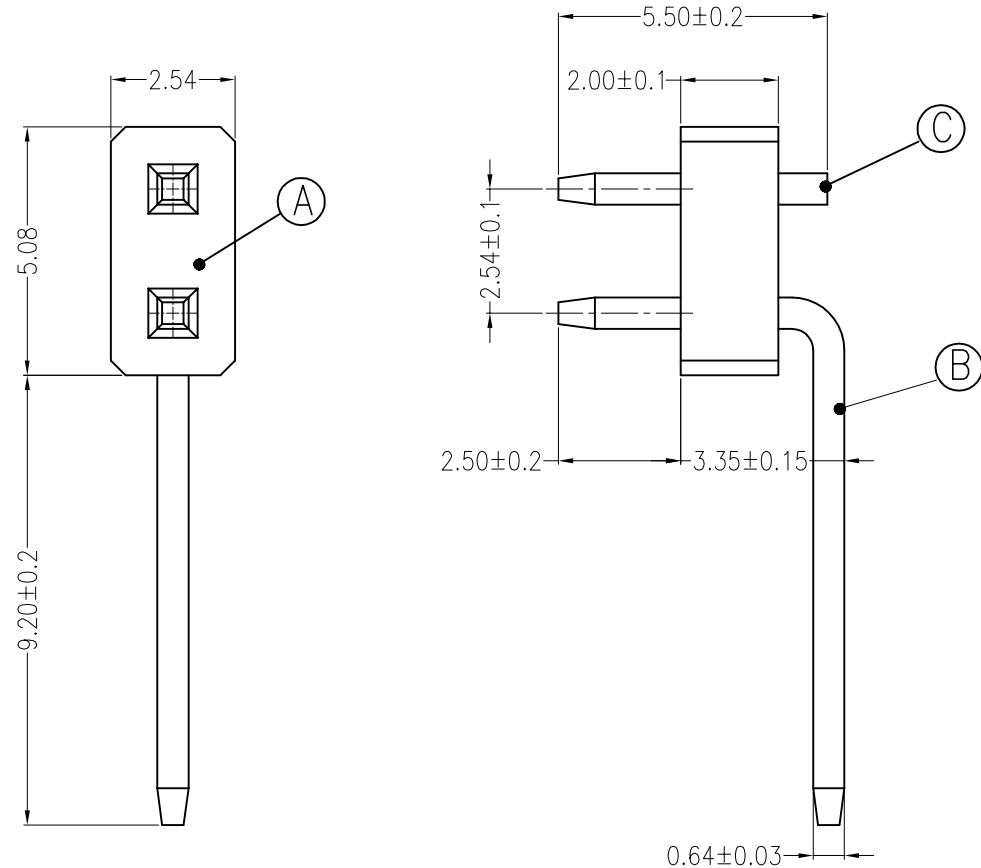

Board Layout
General Tolerance: ±0.05

主要技术参数 Main Specifications

- 接触电阻 (Contact resistance): $\leq 20m\Omega$
- 绝缘电阻 (Insulation resistance): $\geq 1000M\Omega$
- 额定电压 (Rated voltage): 250V AC DC
- 额定电流 (Rated current): 1.0A AC DC
- 耐电压 (Withstand Voltage): 1000V AC/minute
- 温度范围 (Temperature Range): $-40^{\circ}C \sim +110^{\circ}C$

ORDER INFORMATION:

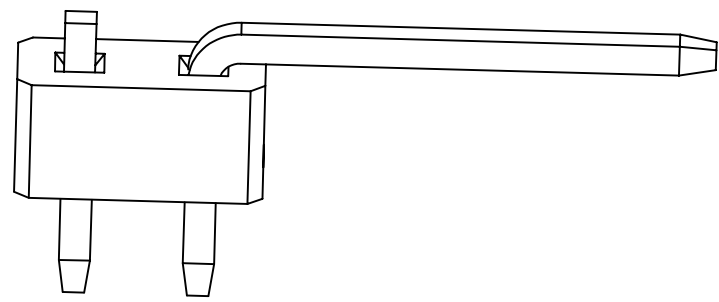
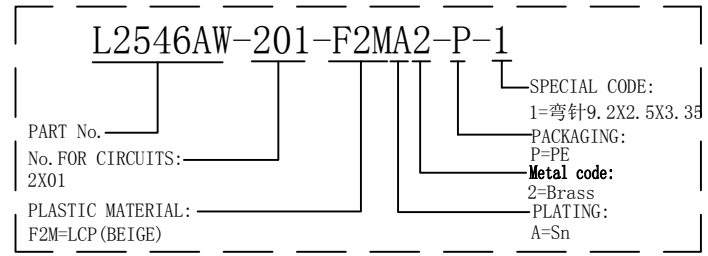

A B C D

E F

C	CONTACT		1 PCS	Brass	Sn-plated
B	CONTACT		1 PCS	Brass	Sn-plated
A	HOUSING		1 PCS	LCP	UL 94V-0, COLOR:BEIGE
ITEM	COMPONENT	Q'TY	MATERIAL	FINISH	

東莞市高迪电子有限公司
DONG GUAN GAO DI ELECTRONICS CO., LTD

TITLE: L2546AW
2.54Pitch 90°wafer dip type

.X±0.35	X.±	USE:	CUSTOMER	
.XX±0.25	.X±	APPD: 邵敬和		
.XXX±0.15	.XX±	CHKD: 田峰	PART NO.: L2546AW-201-F2MA2-P-1	
--	--	DR: 吴丹平		DWG NO.: GCCP-0297
UNITS: mm		DR: 吴丹平	SCALE: 1 : 1	SHEET: 1 / 1